



Jubilee Street, London, E1

BUTLER  STAG



Three double bedroom split-level maisonette conveniently located between the stations of Stepney Green and Whitechapel.



- Three Double Bedroom Maisonette
- Two Shower Rooms
- Perfect for Three Professionals
- Furnished
- Newly Redecorated Throughout
- Rear Garden
- Close to Whitechapel Station
- Available Now!

Newly redecorated throughout, this property is perfectly suited to three sharing professionals looking for a spacious home well connected to the city.

Offered furnished and available now, the property comprises of three true double bedrooms, an additional study room, two shower rooms, separate WC and an open-plan kitchen / living room. Further benefitting from a private rear garden which opens out onto a communal green space and plenty of internal storage.

EPC Rating C
Council Tax Band B

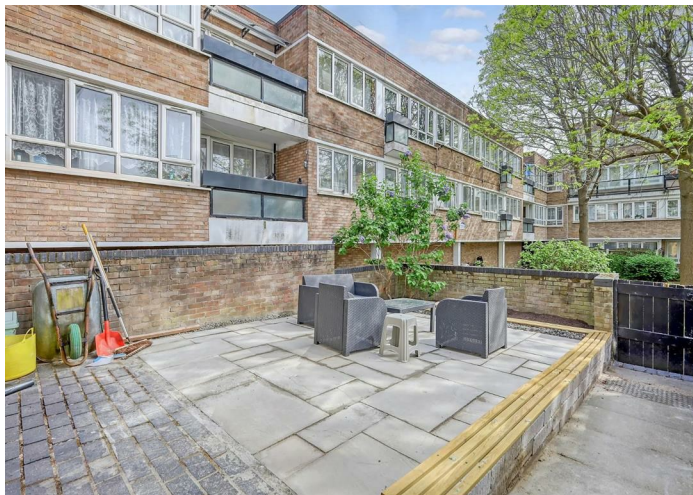



Jubilee Street



Approx. Gross Internal Area 79.5 sq. metres (856.2 sq. feet)

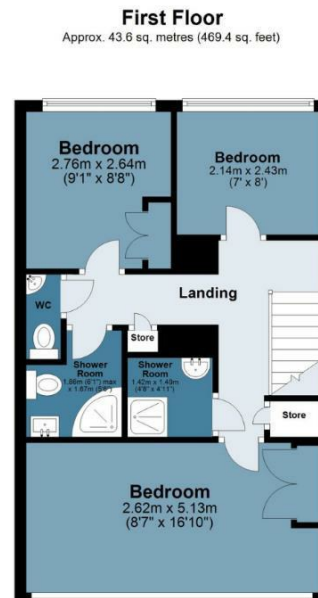
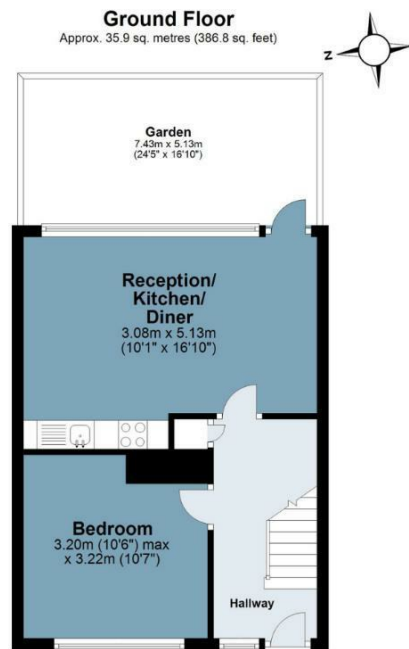

Measurements are approximate and for illustration purposes only. While we do not doubt the accuracy and completeness, we advise you conduct a careful independent assessment of the property to determine monetary value
© @modephoto.uk www.modephoto.co.uk

IMPORTANT NOTICE - These particulars have been prepared in good faith and they are not intended to constitute part of an offer or contract. We have not performed a structural survey on this property and the services, appliances and specific fittings have not been tested. All photographs, measurements, floor plans and distances referred to are given as a guide and should not be relied upon.

BUTLER & STAG

☎ 020 8102 1236

🏠 508 Roman Road, Bow, London, E3 5LU

✉ bow@butlerandstag.com

www.butlerandstag.uk